

REV.	ECN NO	LOCATIONS	DESCRIPTION	DATE	REVISER	APPR

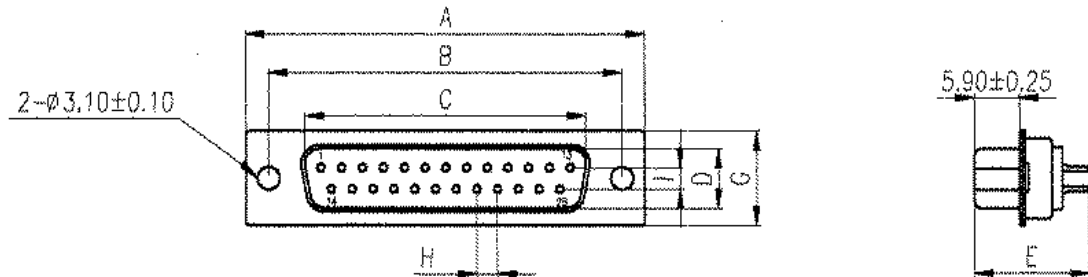

Note:

1. Material:

- 1.1 Insulator: P.B.T UL 94-V0 rated.
- 1.2 Contact: Brass, t=0.20mm.
- 1.3 Shell: Cold rolled steel, t=0.40mm.

2. Specification:

- 2.1 Current rating: 1 A Max.
- 2.2 Dielectric withstanding voltage: 500 V(ac) for 1 minute.
- 2.3 Contact resistance: 30 mΩ Max.
- 2.4 Insulation resistance: 1000 MΩ Min at DC 500V.
- 2.5 Total unmating force: 7.0 Kgf Max.
- 2.6 Total unmating force: 3.0 Kgf Min.
- 2.7 Temperature range: -55°C~+105°C

3. Finishes:

- 3.1 contacts: Gold flashed 1u", 3u", 5u", 10u", 15u", 30u".
- 3.2 Shell: Nickel, tin or gold plated

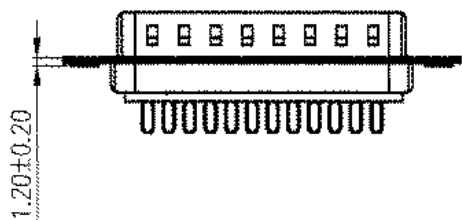

A	前铆型(不通孔)	B	后铆型(通孔)

No.	Part Name	Q'ty	Material	Remarks & Thickness	Finish
6	8.0 Nut	2	Brass	H4.75*8.0	Nickel Plated
5	3B Nut	2	Brass	H4.75*4.75	Nickel Plated
4	Back-shell	1	Cold Rolled Steel	T=0.40mm	Tin Plated
3	Front-shell	1	Cold Rolled Steel	T=0.40mm	Nickel Plated
2	Contact	9~37	Brass	T=0.20mm	Gold Flashed
1	Housing	1	P.B.T	UL 94-V0	Black/Blue/Wi

PART NO	A±0.25	B±0.25	C±0.25	D±0.25	E±0.25	G±0.25	H±0.20	I±0.20
DB-09P	30.80	25.00	16.92	8.30	15.30	12.60	2.77	2.84
DB-15P	39.20	33.32	25.25	8.30	15.30	12.60	2.77	2.84
DB-25P	53.05	47.04	38.96	8.30	15.30	12.60	2.77	2.84
DB-37P	69.40	63.50	55.42	8.30	15.30	12.60	2.77	2.84

UNIT	mm	Projection	Secom International Enterprise Co., Ltd.			
TOLERANCES			TITLE			
General Tolerance			D-SUB male type connector			
Angle Tolerance			PART NO. DSUB-SDP-xxPxx			
x - ±			x - ±1°			
.x - +0.3			.x - +			
.xx - ±0.1						
.xxx - +0.1						
DRAWN	Kevin	DATE	2006/10/12			
SCALE	1:1	SIZE	A4			
SHEET	1/1	REV	A0			