

1 2 3 4 5 6 7 8

SPR-251
Right Angle

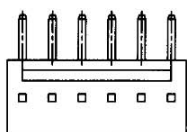

inches
mm

SPS-251
Straight Angle

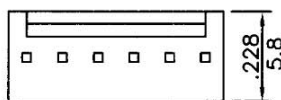

.228
5.8

$.100 \pm .002$
 2.54 ± 0.05

$\phi .047 \pm .002$
 $\phi 1.2 \pm 0.05$

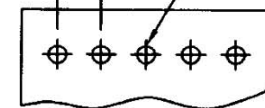

P.C. Board Layout

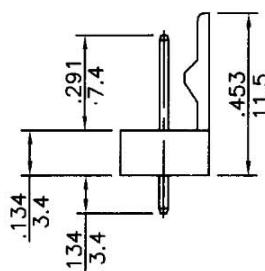
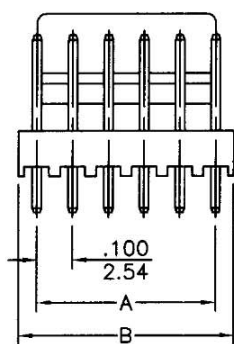
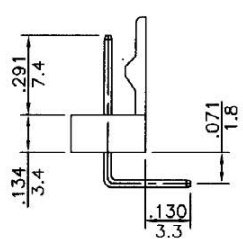
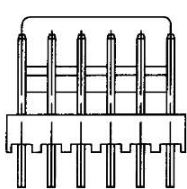

Specifications

- * Current rating: 3A AC, DC
- * Voltage rating: 250V AC, DC
- * Temperature range: -25°C~+85°C
- * Insulation resistance: 1,000M Ω min.
- * Withstand voltage: 1,000 AC/minute
- * Applicable PC board thickness: .063" (1.6mm)
- * Poles: 2-20
- * Material: Insulator: NYLON UL 94V-2, Color Ivory
- * Contact: 0.64mm(.025") square pin, brass, tin plated

SPR1-251

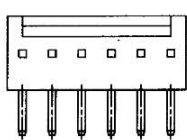

(SPECIAL TYPE)
90° OPPOSITE DIRECTION

Dimensional Information(mm)		
Circuits	A	B
2	0.12(5.4)	0.2(5.08)
6	0.5(12.7)	0.6(15.24)

Circuits : 2~20

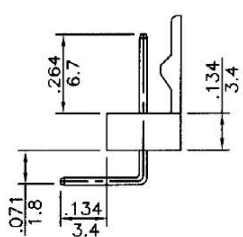
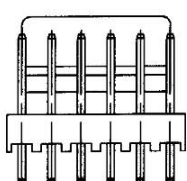

UNIT	mm	Projection		Secon International Enterprise Co., Ltd.			
TOLERANCES				TITLE			
x. = ± Angle = ± 5° .x = ± 0.38 .xx = ± 0.25				.100"(2.54mm) Pitch Single Row Pin Headers			
DRAWN	Kevin	DATE	2009/10/12	PART NO.	SPx-251-1xx		
SCALE	1:1	SIZE	A4	SHEET	1/1	REV	A1

1 2 3 4 5 6 7 8

F
E
D
C
B
A

F
E
D
C
B
A