

- * Poles: 2-20
- * Material: Insulator: NYLON UL 94V-2, Color Ivory
- * Contact: 0.64mm (.025") square pin, brass, tin plated 60u"
- * Mates with CH251 series housing

Specifications

- * Current rating: 3A AC, DC
- * Voltage rating: 250V AC, DC
- * Temperature range: -25°C ~ +85°C
- * Insulation resistance: 1,000M Ω min.
- * Withstand voltage: 1,000 AC/minute
- * Applicable PC board thickness: .063" (1.6mm)

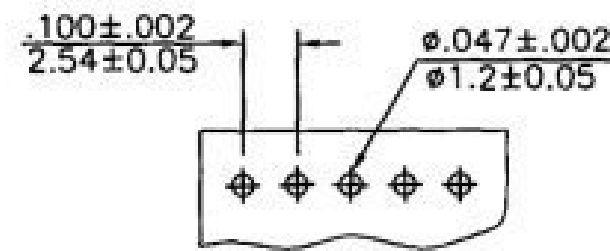

P.C. Board Layout

CIRCUITS	DIMENSION in.(mm)		CIRCUITS	DIMENSION in.(mm)	
	A	B		A	B
2	0.100(2.54)	0.200(5.08)	12	1.100(27.94)	1.200(30.48)
3	0.200(5.08)	0.300(7.62)	13	1.200(30.48)	1.300(33.02)
4	0.300(7.62)	0.400(10.16)	14	1.300(33.02)	1.400(35.56)
5	0.400(10.16)	0.500(12.70)	15	1.400(35.56)	1.500(38.10)
6	0.500(12.70)	0.600(15.24)	16	1.500(38.10)	1.600(40.64)
7	0.600(15.24)	0.700(17.78)	17	1.600(40.64)	1.700(43.18)
8	0.700(17.78)	0.800(20.32)	18	1.700(43.18)	1.800(45.72)
9	0.800(20.32)	0.900(22.86)	19	1.800(45.72)	1.900(48.26)
10	0.900(22.86)	1.000(25.40)	20	1.900(48.26)	2.000(50.80)
11	1.000(25.40)	1.100(27.94)			

SPS-2514 SERIES
Straight Angle

SPR-2514 SERIES
Right Angle

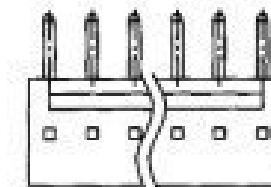
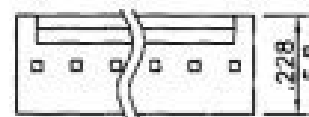

inches
mm

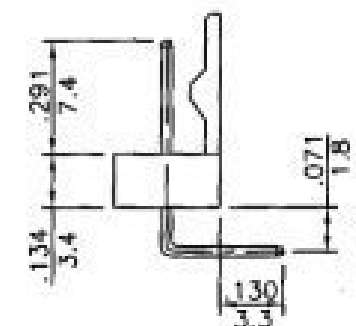
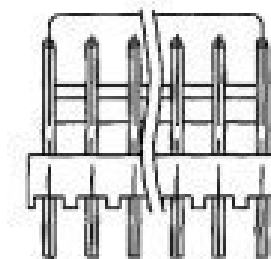
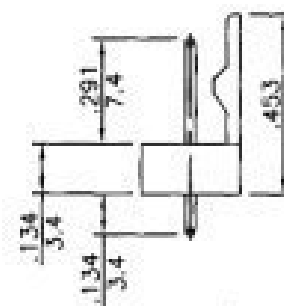
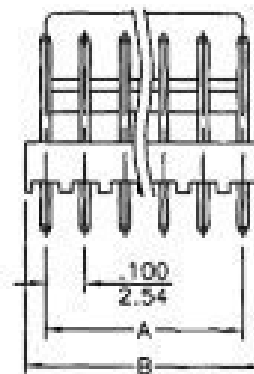

S P X - 2514 - 1 XX 3

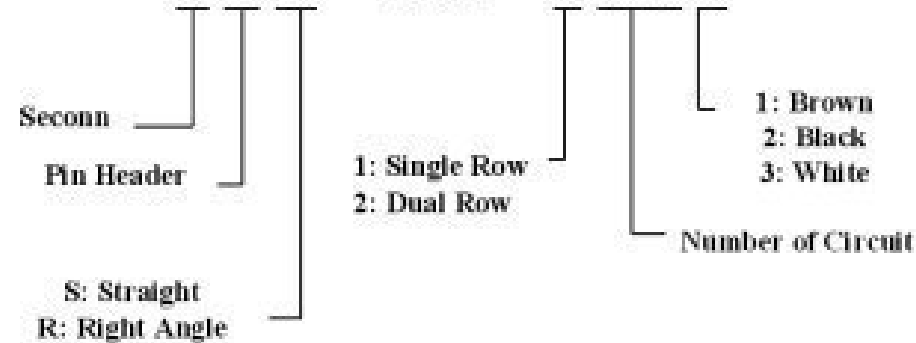

UNIT	mm			Se - Secom International Enterprise Co., Ltd.			
TOLERANCES				TITLE			
				.100" (2.54mm) Pitch Single Row Pin Headers			
DRAWN				PART NO.		SPS-2514-1XX3	
SCALE				SHEET		L1 REV	
				DATE		A4	
				SIZE		A4	